

# THE MYSTERY OF THE MISSING SCIENTIST

## A FANMADE TROUBLESHOOTERS SCENARIO

### SYNOPSIS

The scientist Ronald Andersson has invited the characters to come visit his laboratory in Seattle during their Easter holidays. He wants to show off his new prototype laser-beam. When the characters arrive to his house he is missing and there seems to be no signs of foul play. The characters are then thrown into the mystery of the missing scientist.

### RUNNING THE ADVENTURE

“The Mystery of the Missing Scientist” is more of an adventure outline, which needs a fair bit of improvisation skill. The scenario was originally written for the convention [Paskcon IX](#) and intended to be run with 4-5 novice players in 4 hours. Unfortunately, I had to cancel the scenario due to falling ill, but decided to make it available in this format instead.

### STARTING THE ADVENTURE

The adventures start with the characters arriving at Seattle–Tacoma International Airport. Sea-Tac is an airport that has grown rapidly the last few years, mainly because of the world’s fair of 1962 and the introduction of more regional airliners such as the Boeing 727. Ronald were supposed arrange for them to be met at the airport, but no one seems to be there to meet them. After sorting the mess up, and probably taking a cab, they should be able to get to their hotel, the Camlin Hotel in downtown Seattle. Any attempt to contact Ronald will fail and it seems like he has completely forgotten about the characters.

informs the characters that Ronald has not been there for a few days. With some persuasion they can get someone to unlock the lab and discover that it has been mostly cleared out. There is no sign of his research or any prototype, but there is an empty filing cabinet and several tools spread out in the lab. There is also no sign of a break-in or some kind of struggle, suggesting that the lab was cleared out peacefully. Clues to find at this location includes another picture of Ronald and his daughter Nancy, a (fake) business card for an FBI special agent named Stephen Smith and the testimony of a student that there was a big black 4x4 truck parked at the university loading bay a few days ago.

### THE MISSING SCIENTIST

The characters will probably try and contact Ronald, but as mentioned earlier he is nowhere to be found.

**Ronald’s apartment:** If the characters go to his apartment and does some investigation the clues suggest that he has not been home for a few days. The plants in the windows are dying and the mailbox is full. If they break in or convince the landlord to open up they find additional clues like a picture of Ronald and his daughter Nancy, a receipt for a new pair of hiking boots as well as a map of all the national forests in the pacific north-west area.

**Ronald’s lab:** If the characters go to Ronald’s lab at Seattle University, the faculty

### THE DAUGHTER

If the characters go looking for Nancy Andersson, Ronald’s daughter, she is not hard to find. She runs a flower shop in downtown Seattle and is listed in the phone book. Nancy has not seen her father for days, but knows a bit more. If the character gives the impression of being trustworthy, and does not act like foreign spies, she will tell them that her father has left her a note. See handout 2. The note that he has left her states that he is in peril because of his research. Foreign spies are after his laser prototype and will stop at nothing to get it. He has been warned of this danger by the local FBI

and will be in their protective custody until the spies are caught and the danger is over.

## **CONTACTING THE FBI**

If the characters try and contact the FBI, it becomes obvious that the FBI office is on full alert for some reason. They will have to wait a while, but in the end, they will be put in contact with Special Agent Andrew Ingram. He is very helpful and interested in hearing what the characters know, especially if they happen mention anything regarding lasers. Andy orders his secretary Carl to look in their records, but Carl swiftly returns stating that there is no active file on Ronald Andersson nor any local FBI agent called Stephen Smith. He has contacted the head office, but it will take time for them to get back with the information. When the characters have told Andy everything they know, he will in confidence tell them about the threat.

## **THE THREAT**

A well-kept secret in the US government is that last night a NASA satellite was shot down by a high-powered laser beam originating from the Pacific Northwest area. Shortly thereafter a ransom demand was phoned in to the Pentagon, claiming it was just a power demonstration and that the US government needs to pay 20 million USD within a week or

have all of their satellites shot down. All US agencies have tried to find solid leads but have drawn a blank. The best lead they have is from the scientists at FBI, that tried to calculate the origin of the beam. Their best guess was a rather deserted area of Mount Baker National Forest. FBI has been there all day and have found nothing suspicious in the area. They even requisitioned a helicopter and surveyed the area but still found nothing.

## **SOMEONE IS WATCHING**

Gordon Summer, former police now working for the Octopus, is watching the Professor Andersson's apartment and Nancy to make sure that no one comes looking for the Professor. Gordon does not want to know the details of the operation, it's safer not to know and just do what he is paid to do, nothing more, nothing less. He will most likely spot the characters and act. The first thing he will do is to alert his contact, Kimberly Brown, so she is aware of the characters. After that Gordon will try to find a way to scare the characters into stop snooping around. If Gordon is defeated or captured it might be a good place to add extra clues that points the characters to Mount Baker National Forest.

# INTO THE WILD

## MOUNT BAKER NATIONAL FOREST

The characters should be given an increasing number of clues pointing towards Mount Baker National Forest. If the characters do not have a helicopter or the funds to rent one they will need to get to the remote area by foot. While shopping for the necessary hiking equipment they will also find good maps of the area, but since neither of the characters know the area well they will be recommended to use a guide. If they ask the FBI for advice they can recommend a local guide, Kimberly Brown, they have been using in their search the area.

## THE GUIDE

When the characters arrive at Mount Baker National Forest they are met by Kimberly Brown, an employee of The United States Forest Service (USFS), which manages the national forests. She is very helpful and will gladly help them by being a guide. She also comes highly recommended by the FBI and anyone else the characters might talk to. Kimberly informs them that the area in which the laser beam is supposedly fired from is not possible to do in one day, they will have to make camp during the night. She has all the necessary equipment and will provide what the characters need.

What the characters don't know is that Kimberly is also a member of the Octopus and is in charge of keeping people away from the hidden Octopus base located in Mount Baker National Forest. She and her henchmen volunteers as guides in order to know who are entering the forest. If someone is about to get too close to the base she will use her expert wilderness knowledge and create or facilitate an unfortunate accident.

If the characters confront or catch Kimberly red-handed she will try and avoid direct combat and try to escape by outrunning them in the woods. If she gets away she will alert the hidden base of their presence.

## THE HIDDEN BASE

There is a hidden base inside a smaller mountain with a secret entrance behind a small waterfall. If they have rough coordinates and spend some time looking, it should not be that hard to find the hidden base.

There is a platform inside the mountain that can be raised. On that platform there is a helicopter pad and professor Andersson's laser beam. If the characters have problems locating the base, there is a possibility that a helicopter will land at the base carrying supplies, giving away its location.

If the characters fly over the mountain with the hidden Octopus base, instead of approaching by foot, Mr. Smith will be a bit spooked. He will raise the platform and fire with the laser at their helicopter. If it is hit it will be forced to do an emergency landing. Mr. Smith will then contact Kimberly Brown and have her try to "escort" any survivors from the wreckage back to civilisation.

A layout of the base can be found as handout 3A and 3B and there is a brief description of each room in Appendix A. If the base has not been warned by Kimberly Brown or seen a suspicious helicopter, the security is rather relaxed and the characters can try to sneak in undetected. If Mr. Smith has been alerted of their presence, there will be armed guards posted not just in the guard room but in other locations as well.

The characters should be able to find Professor Andersson in the laboratory during daytime and in the dormitory during the night. He firmly believes that he is working for the FBI and that they are shielding him from foreign spies that wants the laser prototype. He is too absent-minded to really pick up any clues that he is actually working for a nefarious organisation like the Octopus.

## **THE PLOT**

Hearing of the revolutionary laser beam, Mr. Smith made a cunning plan. He dressed himself and his henchmen as FBI-agents and contacted Professor Andersson. Agent Smith presented fabricated evidence and convinced Professor Andersson that he was in danger and that foreign spies were after his laser beam. He was to be put in protective custody at a secret location in Mount Baker National Forest where he could complete his research. While he was doing his research, FBI would apprehend the spies to guarantee his safety. In reality Mr. Smith uses the prototype to extort money from the government and when he no longer has any use of the laser prototype sell it to the highest bidder.

Professor Andersson has completed his prototype but is still sorting out a few quirks. The Absent-minded professor knows nothing about the threat or that his laser has been used for shooting down satellites. He just believes that he is working with competent and trustworthy government scientists in order to create a more powerful laser that will benefit mankind.

## **THE SHOWDOWN**

If the character tries to free Professor Andersson, they will have to convince him that he is not working together with the real FBI. This is not an easy task and he will require solid arguments or irrefutable evidence in order to try to escape the base. Additionally, if he is aware that he has been tricked, Professor Andersson will not leave until they have rendered the laser prototype inoperable. This is not a trivial thing to do, but could be done at the helicopter pad or at the control station.

The odds of running into Mr. Smith increase with the time they spend in the base and it will trigger a classic showdown between the character and the Octopus. Mr. Smith is not very brave and if it seems like they are losing he will activate his remote trigger that will activate a pre-programmed procedure. The procedure will slowly raise the platform and then fire the laser at one American satellite at a time. His hope is that forcing the characters to disarm the laser will distract them long enough to allow him to flee via his secret escape tunnel.

# TREATH FILES

## THE GOOD GUYS

### PROFESSOR RONALD ANDERSSON

Ronald Andersson is a renowned scientist and one of the foremost experts in laser-technology. He currently does his research at the University of Seattle.

**Ronald Andersson****Initiative:** 4 **Vitality:** 4**Skills:** Basic 35%, Specialist (Science) 85%, Engineering 75%, Absent-mindedness 65%

### NANCY ANDERSSON

Nancy Andersson is the daughter of Ronald Andersson and runs a flower shop called Flower Power in downtown Seattle.

**Nancy Andersson****Initiative:** 4 **Vitality:** 4**Skills:** Basic 25%, Specialist 65%, Flower arranging 75%, Fashion sense 80%

### SPECIAL AGENT ANDREW INGRAM

Andy Ingram is an FBI Special Agent at the Seattle office. He has many years of experience within law enforcement and has many contacts within the Seattle Area. Currently he is working on the case where a NASA satellite was attacked with a laser beam.

**Andrew 'Andy' Ingram****Tags:** Lieutenant, Flips (2), Multiple Attacks (2)**Initiative:** tacks check **Vitality:** 5**Attacks:**

- Smith&Wesson revolver (1): 65%, 5dX, Loud, Short Range (3), Reload (8-0)

**Defence:** 35%**Skills:** Basic 45%, Specialist 65%, Investigation 65%, Forensics 75%, Law 75%, Build a Case 65%, Intimidation 65%, Interrogation 75%

## THE BAD GUYS

### GORDON SUMMER

Gordon Summer is former police that has retired and now works for the Octopus. Gordon does not like to hurt people but is good at stakeouts and intimidating people. Once spotted he is easy to recognize by his spikey blond hair.

Use the stats for Street Cop in the core rulebook (page 210). But add the skills stakeout and intimidate at 65%.

### KIMBERLY BROWN

Kimberly Brown is a member of the Octopus in charge of keeping people away from the hidden Octopus base in Mount Baker National Forest. She and her henchmen work as guides in order to know who are entering the forest. If someone is about to get to close to the base she will use her expert wilderness knowledge and create an unfortunate accident.

**Kimberly Brown****Initiative:** task check **Vitality:** 7**Attacks:**

- Hunting rifle: 55%, 5dX, Loud, Single Shot
- Grizzly spray: 75%, makes Grizzly bears enraged and attacks target. See core rulebook (page 218) for grizzly stats.

**Defence:** 25%**Skills:** Basic 35%, Specialist 65%, Alertness 65%, Survival 85%, Hiking 85%, Create unfortunate accidents 75%

### OCTOPUS BRUTE

Just regular brutes, but sometimes dressed as FBI agents. Use the stats for Octopus Brutes in the core rulebook (page 215).

## "MR SMITH". #18

Mr Smith is a member of the Octopus that is a master of disguise and trickery. He never shows up using the same name or with the same appearance. For some reason he seems to have a fondness for the surname Smith, which is why he has been nicknamed "Mr Smith". His real name is unknown but rumour has it that he is a failed actor that turned to crime. In this adventure he appears as FBI Special Agent Stephen Smith.

### "Mr Smith"

**Initiative:** task check **Vitality:** 8

#### Attacks:

- Smith&Wesson revolver (1): 65%, 5dX, Loud, Short Range (3), Reload (8-0)
- Telescopic baton: 65%. 3dX

**Defence:** 40%

**Skills:** Basic 35%, Specialist 65%, Alertness 65%, Nine Lives 75%, Acting 70%, Disguise 95%, Quick-change clothes 85%, Escape captivity 75%

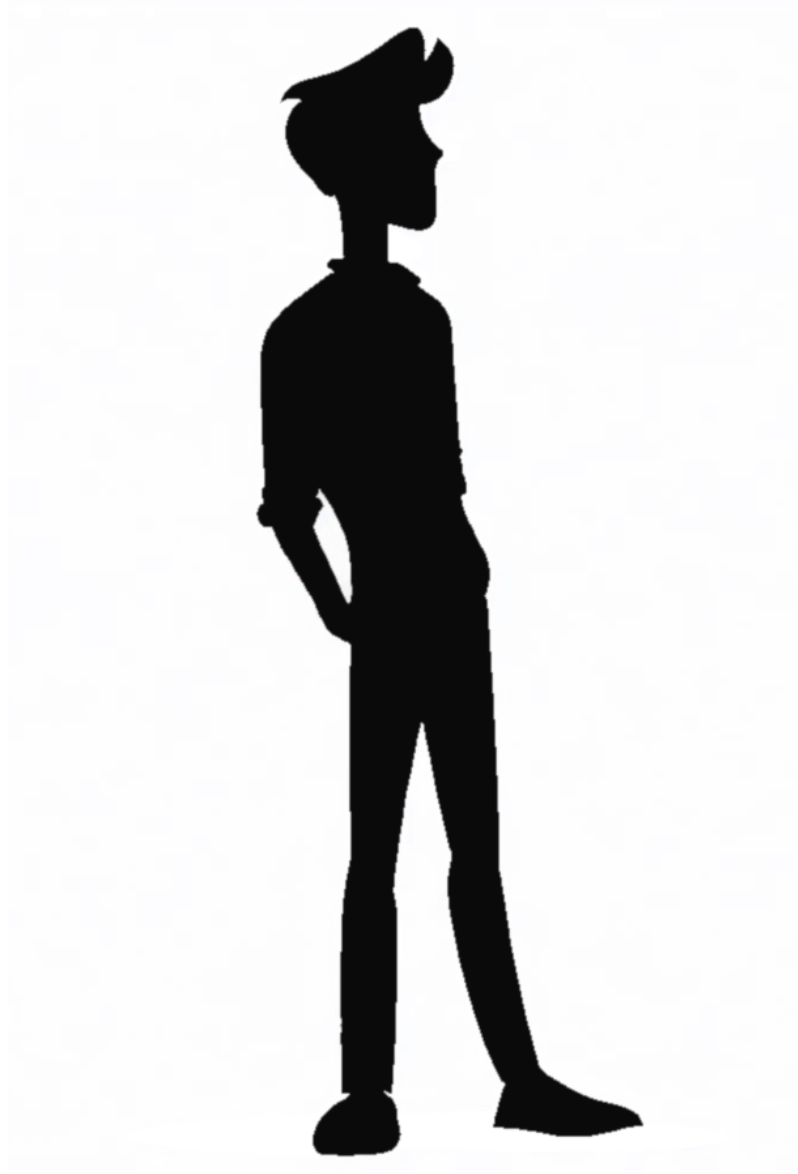

## APPENDIX A – THE SECRET LAIR

### A. Helipad and Laser

This is a big platform that can be raised inside the mountain, making a helicopter pad and Professor Andersson's bulky Laser Beam visible. It is not possible to fire the laser, land or leave with the helicopter when the platform has not been raised.

### B. Conference room

This is just a regular conference room for when the Octopus needs to hold strategy meetings discussing world domination. On the conference room table is a half-eaten Pineapple Upside-Down Cake, that is left from the last meeting.

### C. Supply room

This is where all the supplies are kept. Everything from office supplies, toilet paper, ammunition and spare parts. There is also a big walk-in refrigerator with food.

### D. Toilet

This is the room the Octopus-members use when they are in dire need.

### E. Security central

This is the inner security team of the base. There are three Octopus Brutes dressed as FBI agents here at all times. They have walkie-talkies and stay in contact with other guards regularly. Every half hour one of these guards makes a security sweep around the corridors of the base.

### F. Mr. Smith's office

This is Mr Smith's personal office. There is a large luxurious wooden desk he usually sits behind every day. Behind him on the wall are fake diplomas from the FBI Academy. Under the desk is a silent alarm that can call in two octopus brutes dressed as FBI agents.

### G. Generator

This is the generator that powers the entire base. It is based on weird tech and not easy to power down.

### H. Workshop

This is the room where things get built or repaired at the base and there are a vast number of tools here. The laser prototype was built here after Professor Andersson's specifications. There is also a fair amount of spare parts for the generator and the helicopter lying in here.

### I. Control room

This is where the laser is operated. The walls have large panels with buttons, levers and blinking lights. There are two control stations with chairs where the two operators can sit and monitor the status of the laser beam on television screens.

### J. Broom closet

This is where the Octopus-janitor keeps all his cleaning supplies. There is a cleaning cart and a large selection of Octopus-approved detergents.

### K. Smith's secretary

This is where Mr Smith's secretary, Pierre, sits. Pierre is always 100% professional and always very courteous when dealing with visitors. He has a big bowl of candy that he offers from to visitors that have to wait until Mr Smith is available.

### L. Dormitory

This is where Professor Andersson and all of the Octopus employees sleep. There are four security guards (Octopus Brutes) sleeping here during daytime, and the rest sleep here during night-time.

### M. Mess hall

This is where everyone eats three meals a day. There are three long tables and a kitchen area. The chef is actually an Octopus brute that has secret dreams of becoming a master chef. He tries new elaborate recipes every day with various results.

**N. Offices**

This is where the administrative staff of the base works and Octopus scientists document their findings. There are four desks with typewriters and several bookshelves filled with binders of documents.

**O. Laboratory**

This is the lab where the Octopus scientist work on building prototypes together with Professor Andersson. There are a lot of vacuum tubes, transistors, resistors and a lot of doohickeys that the scientist need to improve or miniaturize Professor Andersson's prototype laser beam or any other devices they are working on.

**P. Inner laboratory**

This is Professor Andersson's personal working space during daytime. There is a thin sound proofed glass wall between him and the other scientists so that he can work undisturbed with sorting out the quirks of his laser prototype.

**Q. Guard room**

This is the outer security force of the base. There are always two armed guards in the fortified guard house, verifying that all that enter through the waterfall are authorized to be there. It is a tedious task and if the base is not on alert it is very likely that the guards are playing cards instead of actually surveying the area.



Handout 1: Professor Andersson's letter

Seattle  
Washington  
March 12

Dear Friends,

I hope this letter finds you in good health and high spirits. It is with great pleasure and excitement that I extend an invitation to all of you to visit me in beautiful Seattle for an exclusive opportunity to witness my latest creation: a groundbreaking new laser prototype.

As we discussed in Paris last year, I have dedicated a substantial amount of time and effort to this project over the past few years, and I am thrilled to announce that we have made significant progress. This laser prototype represents a major breakthrough in the field, and I cannot wait to share it with all of you. It is based on a completely different principle than the one Maiman built a few years ago and, if I am correct, is ten times as powerful.

The visit will take place during your Easter break and will include a comprehensive tour of my state-of-the-art laboratory facilities, where you will have the chance to see the laser prototype in action. Additionally, we will have engaging discussions, exchange ideas, and perhaps even conduct some experiments together.

I am eagerly awaiting your positive response and the opportunity to host you in Seattle and show you the city's charm and attractions.

Warmest regards,

Professor Ronald Andersson

## Handout 2: Nancy's note

Sweet Nancy,

I'm in a tight spot due to my research. Foreign spies want my laser prototype. The FBI is protecting me until they catch them. Don't worry, I'll be safe. Love you always.

Dad

Handout 3A: Map of the Base (Without text)

MAP: THE SECRET LAIR



|                |                                |               |                 |  |
|----------------|--------------------------------|---------------|-----------------|--|
| Replaces       | Mt. Baker National Forest Base |               | Revisions       |  |
| Replaced by    |                                |               |                 |  |
| Date           | 1962                           | Type          | Personnel level |  |
| Krakenbau GmbH |                                | Overview plan |                 |  |

Handout 3B: Map of the Base (With text)

MAP: THE SECRET LAIR

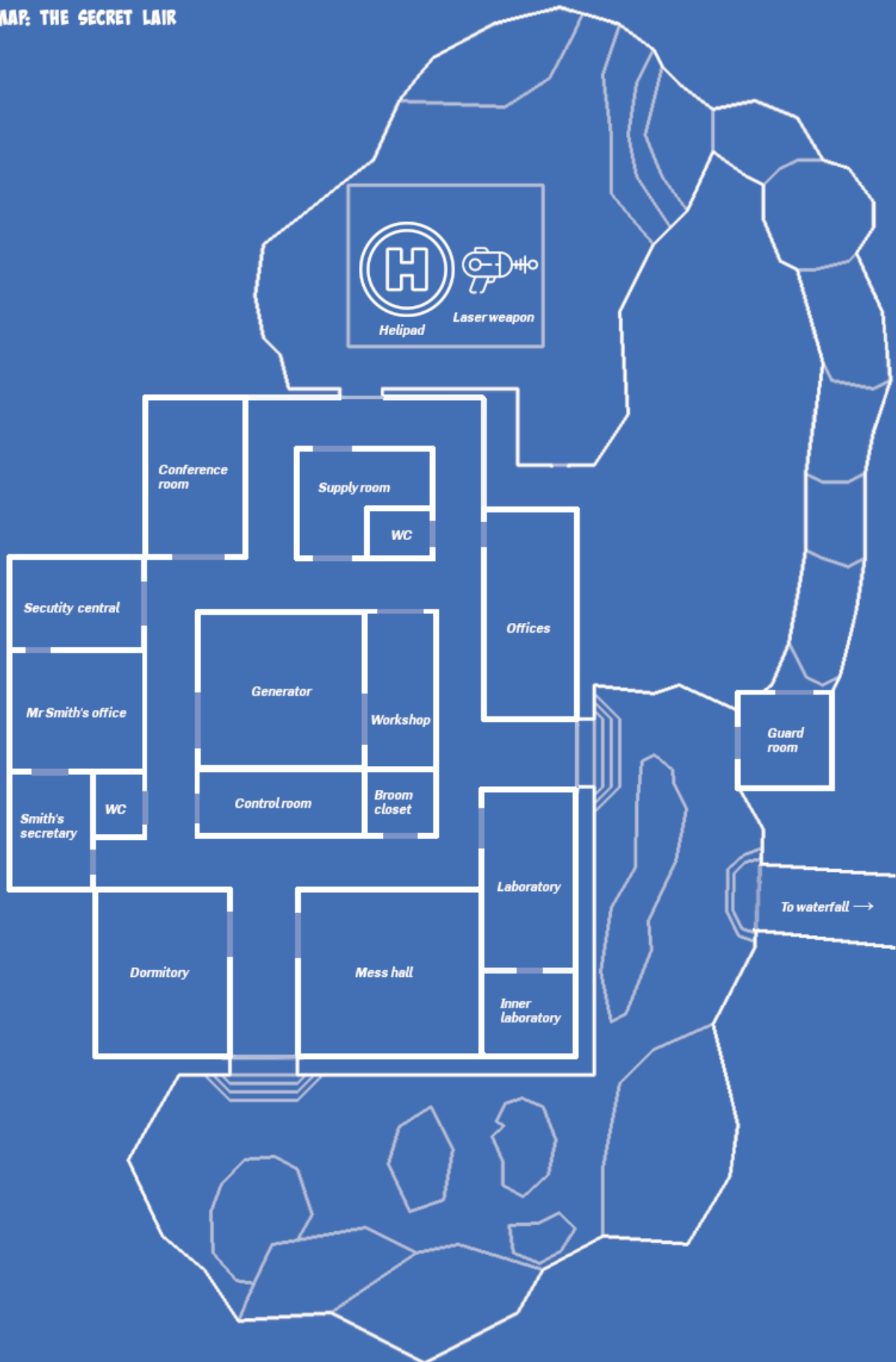

|                |                                |               |                 |  |
|----------------|--------------------------------|---------------|-----------------|--|
| Replaces       | Mt. Baker National Forest Base |               | Revisions       |  |
| Replaced by    |                                |               |                 |  |
| Date           | 1962                           | Type          | Personnel level |  |
| Krakenbau GmbH |                                | Overview plan |                 |  |